

# TCO09UYG

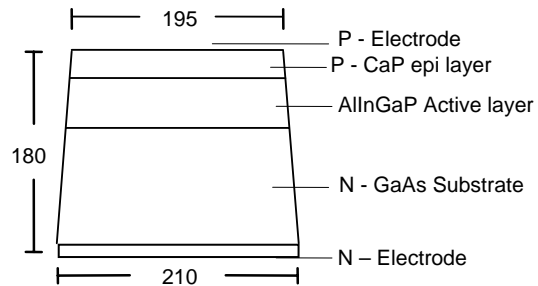

## ❖ Outline Dimensions:

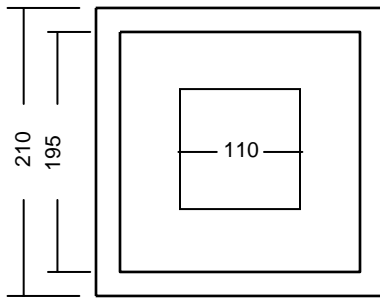

## ❖ Physical Structure:

Chip dimensions		Chip size	9 mil x 9 mil	185 $\mu\text{m}$ x 185 $\mu\text{m}$
		Thickness	7.1 mil	180 $\mu\text{m}$
		Emission area	7.7 mil	195 $\mu\text{m}$
		Bonding pad	4.3 mil	110 $\mu\text{m}$
Electrode	Top	P (anode)	Aluminum (Gold optional)	
	Backside	N (cathode)	Gold alloy	
Surface condition		Not frosted		

## ❖ Electro-Optical Characteristics:

Parameter	Symbol	Condition	Min.	Typ.	Max.	Unit
Forward Voltage	$V_F$	$I_F = 20\text{mA}$	-	2.05	2.4	V
Wavelength	$\lambda_P$	$I_F = 20\text{mA}$	-	593	-	nm
	Hue	$I_F = 20\text{mA}$	585	590	595	
Spectral width at half height	$\Delta\lambda$	$I_F = 20\text{mA}$	-	20	-	nm
Reverse Voltage	$V_R$	$I_R = 10\mu\text{A}$	5	-	-	V
Luminous Intensity	$I_V$	F1	65	-	-	mcd
		H	80	-	-	